

# L0852F

## 安装之前 Before installation

所有的资料是随最新的产品资料编写而成。  
 韦洁洁具有限公司保留任何权利不经通知即可改变产品特性, 包括此产品可获专利的权利。  
 说明书包括重要的安装, 保养及清洁方面的内容, 请仔细阅读并牢记于脑海。  
 注意事项:  
 1. 在安装前请冲洗供水管道以清除管道中的杂质。  
 2. 检查供水管有无损坏, 如有, 请更换。  
 3. 遵守当地管道安装系统。

All information is based on the latest product information. Weiyee sanitary ware Co., Ltd reserves the right to change the product features, packaging or type of offering without notice at any time.  
 Instructions include important installation, maintenance and cleaning aspects. Please submit these information to the user for reading.  
 NOTES:  
 1. Flush the water supply pipes thoroughly to remove debris.  
 2. Inspect the supply pipes is broken or not. If necessary, please replace it.  
 3. Comply local plumbing codes.

## 产品包装部件 Product packaging spare parts

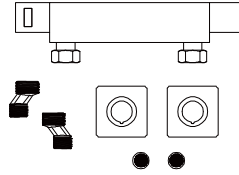

## 安装步骤 Installation steps

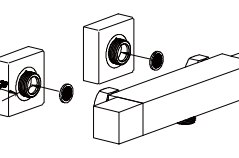
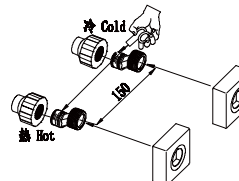

## 安装尺寸 Installation dimension

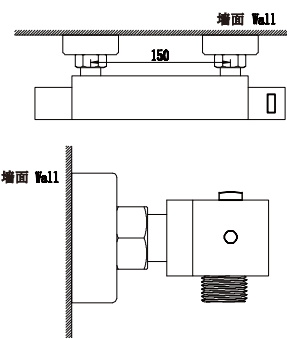

## 使用说明 Instructions

开关龙头及冷热水操作如下图所示  
 Faucet Switch and cold and hot water operation are shown below.

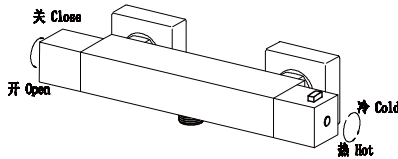

## 零件图 Part drawing

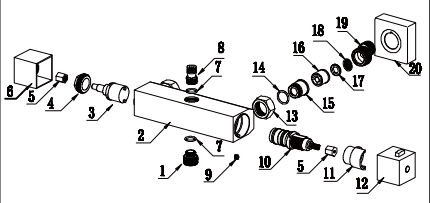

序号	名称	序号	名称	Number	Name	Number	Name
1	下水水接头	11	定位柱	1	Outlet joint	11	Guide pin
2	主体	12	手轮	2	Faucet body	12	handwheel
3	流量阀	13	螺帽	3	flow valve	13	Screw Nuts
4	压帽	14	O型圈	4	Pressing cap	14	O-ring
5	齿套	15	进水接头	5	gear sleeve	15	water inlet joints
6	手轮	16	单向阀	6	handwheel	16	Non-returning valve
7	密封圈	17	压帽	7	Seal ring	17	Pressing cap
8	上出水接头	18	滤网垫片	8	Upper water outlet joint	18	Rubber Gasket With Mesh
9	锁紧螺丝	19	接头	9	screw	19	Joints
10	控温阀	20	装饰罩	10	Temperature control valve	20	Decoration cover